

Flexible Endoscope Cleaning & Disinfection Guide

CYF-VA2

CYF-5A

LF-V

ENF-VT2

Precleaning

1 Wipe the insertion tube



Gently wipe the external surfaces of the insertion tube with a cloth moistened in detergent solution.

2 Aspirate detergent



Aspirate detergent solution for 30 seconds, water for 10 seconds, and air for 10 seconds.

3 Detach accessories



Disconnect all detachable parts.



This guide is only a summary of the steps necessary to properly reprocess your endoscope. Follow the detailed steps outlined in the **ENDOSCOPE REPROCESSING MANUAL** that was included with your endoscope.

Leakage Testing

4 Attach the tester



Attach the leakage tester to the venting connector on the endoscope.

5 Apply pressure



When using MB-155 with MU-1 or the light source

6 Observe



When using WA23070A or A2377
Close the pressure release lever. Press the hand pump so that the pointer stays within the green area.



Immerse the entire endoscope in water, observe for 30 seconds while angulating the bending section and confirm that there is no continuous series of bubbles.
CAUTION: If a leak is detected, remove from water and contact Olympus.

7 Detach the tester



Remove the endoscope from the water and release the air pressure in the endoscope.*
* When using WA23070A or A2377, open the pressure release lever.
* When using MB-155, turn the light source or MU-1 off and detach the leakage tester from the air source. Detach the leakage tester from the endoscope.

Manual Cleaning

8 Brush the channel

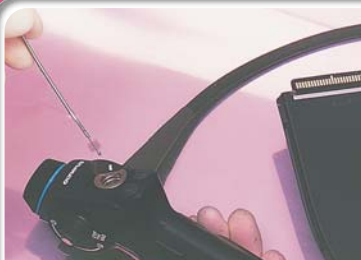

Immerse the endoscope in detergent solution. Clean the external surfaces using a clean cloth. Brush instrument / suction channels, suction cylinder and instrument channel port. Repeat until all debris is removed.

9 Aspirate detergent



Attach the suction cleaning adapter to the instrument channel port and the suction cylinder. Aspirate detergent solution for 30 seconds.

10 Flush detergent



Attach a syringe to the suction opening of the adapter, fill the channel and adapters with detergent solution.

11 Detach accessories



Detach the accessories while keeping the scope immersed in detergent solution. Leave all components to soak in the solution.

12 Clean the surface



Using a lint-free cloth, gently wipe all debris from the endoscope's external surfaces while the endoscope is immersed in detergent solution. Soak in the solution for the time recommended.

Manual Cleaning

13 Rinse the endoscope



Immerse the endoscope in water and rinse. Attach the suction cleaning adapter and aspirate water for 30 seconds and air for 20 seconds.

14 Wipe the surfaces



Use a soft, lint-free cloth to remove excess moisture from the endoscope and cleaning accessories in preparation for disinfection.

Disinfection

15 Flush disinfectant



Immerse the endoscope in disinfectant solution and attach the suction cleaning adapter. Use a syringe to fill the instrument/suction channels and suction cleaning adapter.

16 Disinfect the endoscope



Detach the suction cleaning adapter while immersed and soak for the time specified by the manufacturer.

17 Inject air

Reattach the suction cleaning adapter and use a syringe to flush the channels with air to remove disinfectant solution. Remove endoscope from disinfectant solution.

Rinsing

18 Rinse the surfaces



Immerse the endoscope in water. Using a sterile, lint-free cloth, thoroughly rinse and gently wipe all external surfaces.

19 Rinse the channel



Reattach the suction cleaning adapter to the endoscope and aspirate water for 30 seconds. Remove endoscope from water and aspirate air for 60 seconds.

20 Aspirate alcohol



Aspirate alcohol for 5 seconds and then air for 20 seconds.

21 Wipe the surfaces



Disconnect the suction cleaning adapter. Using a sterile, lint-free cloth, thoroughly and gently wipe and dry the external surfaces of the endoscope.

22 Wipe the surfaces with alcohol



Using a sterile, lint-free cloth moistened with alcohol, thoroughly and gently wipe the external surfaces of the endoscope.

Reprocessing Tools

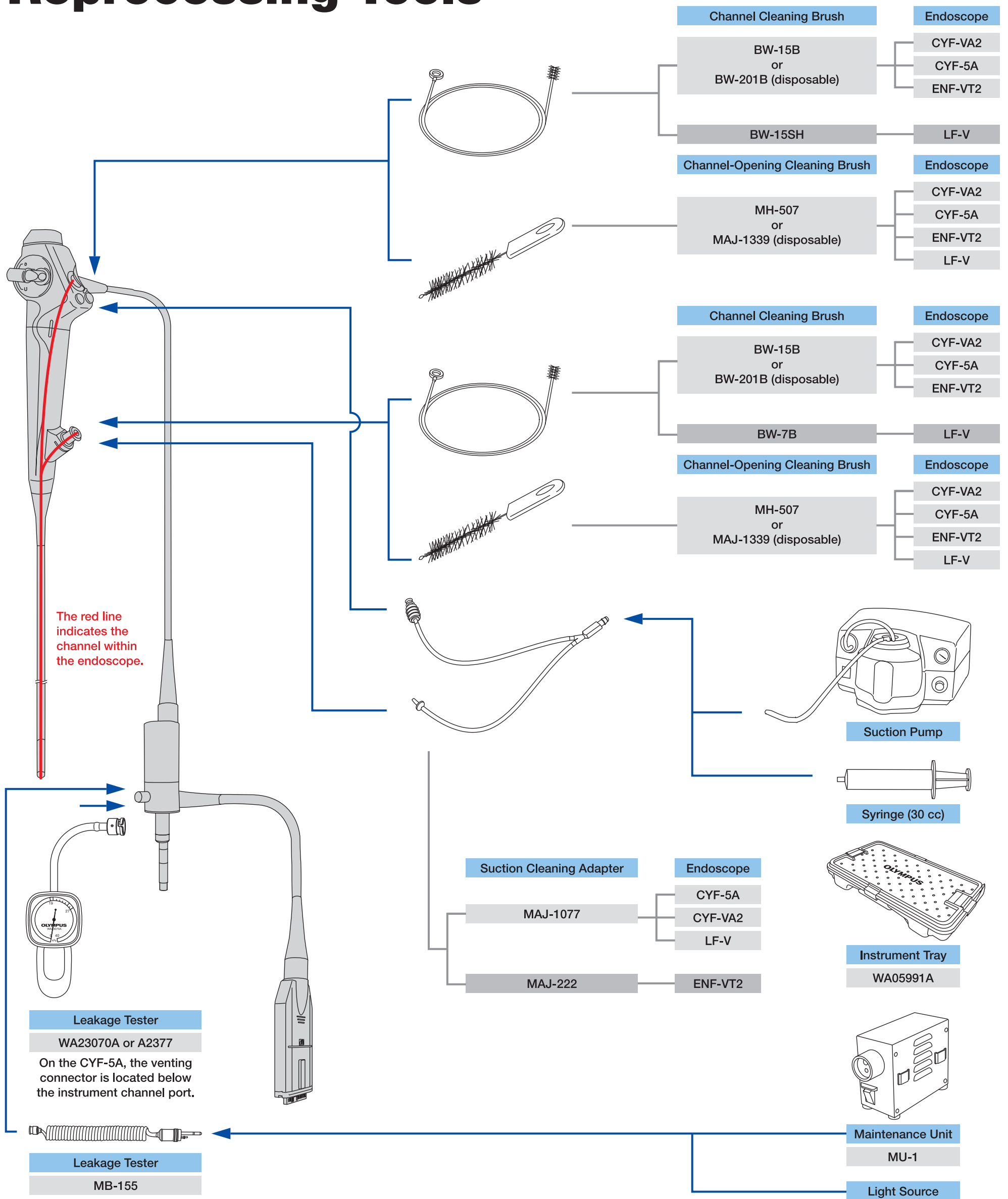

- Clean, disinfect, sterilize each attachment and cleaning accessory according to its instruction manual.
- Always wear personal protective equipment when cleaning, disinfecting, or sterilizing an endoscope.
- ALL channels of the endoscope MUST be cleaned and high-level disinfected or sterilized during EVERY reprocessing cycle, even if the channels were not used during the previous patient procedure.
- Decisions regarding what methods of cleaning, disinfection and sterilization should be used are the responsibility of trained specialists.
- When you use detergent solution and disinfectant solution, always follow the manufacturer's recommendations regarding temperature and soaking time.

OLYMPUS

Your Vision, Our Future