

ENDOSCOPE PRECLEANING GUIDE

EXERA (160), EXERA II (180) & EXERA III (190) Gastroscopes and Colonoscopes

— Refer to companion *ENDOSCOPE CLEANING GUIDE* for additional cleaning information —

WARNING: This guide is only a summary of the steps necessary to properly preclean your endoscope. Be sure to follow the detailed steps outlined in the *ENDOSCOPE REPROCESSING MANUAL* that was included with your endoscope when purchased and in the *ENDOSCOPE CLEANING GUIDE* for a summary of manual cleaning steps.

Be sure to follow precleaning with appropriate leakage testing, manual cleaning, and disinfection steps.

PRECLEANING – Immediately After Use

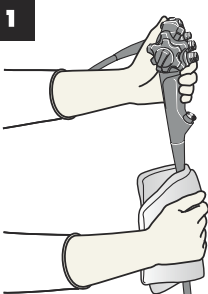

Wipe down insertion tube with an enzymatic detergent-soaked cloth.

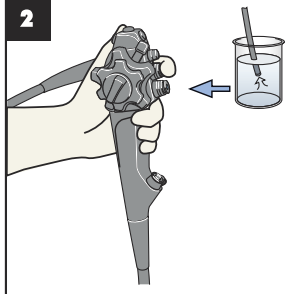

Aspirate enzymatic detergent, then air through the suction channel.

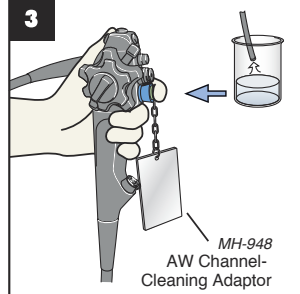

Attach AW channel-cleaning adaptor. Flush water, then air, through air/water channels.

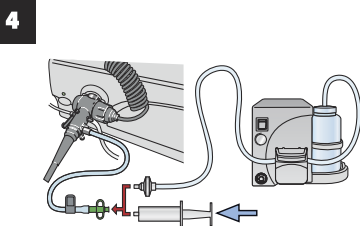

Flush the auxiliary-water channel using the flushing pump. (Alternatively, flush water, then air, into auxiliary water channel using 30ml syringe). The auxiliary water adaptor should remain attached during transport to reprocessing room.

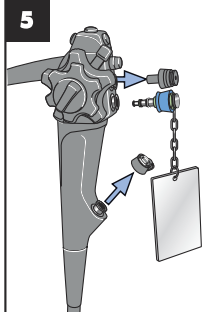

Disconnect all detachable parts.

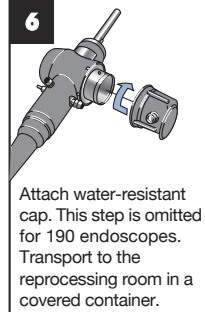

Attach water-resistant cap. This step is omitted for 190 endoscopes. Transport to the reprocessing room in a covered container. **NOTE:** Ensure that the ETO cap is removed prior to leak testing 190 generation scopes.

ENDOSCOPE PRECLEANING GUIDE

Steps for Additional Endoscopes

— Refer to companion *ENDOSCOPE CLEANING GUIDE* for additional cleaning information —

WARNING: This guide is only a summary of the steps necessary to properly preclean your endoscope. Be sure to follow the detailed steps outlined in the *ENDOSCOPE REPROCESSING MANUAL* that was included with your endoscope when purchased and in the *ENDOSCOPE CLEANING GUIDE* for a summary of manual cleaning steps.

Be sure to follow precleaning with appropriate leakage testing, manual cleaning, and disinfection steps.

Duodenoscope (TJF-Q180V)

2

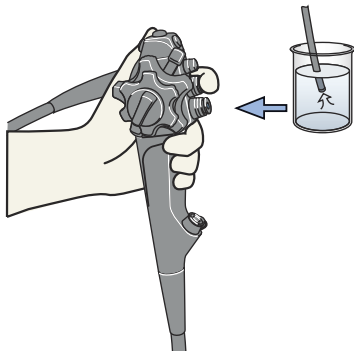

During step 2, continue to aspirate enzymatic detergent through the suction channel while raising and lowering the forceps elevator 3 times.

Endoscopic Ultrasound Linear Endoscope (GF-UCT180)

2

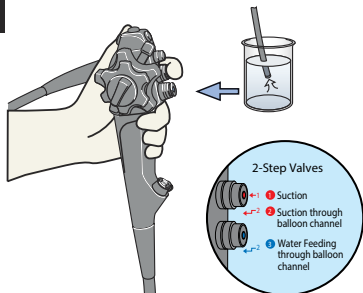

During step 2, aspirate enzymatic detergent, then air, through the suction and balloon channels and feed water into the balloon channel.

4

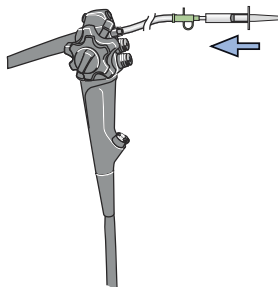

During step 4, flush enzymatic detergent, then air into the elevator wire channel using a 5ml syringe.

For complete product details see Instructions for Use.

OLYMPUS

OLYMPUS AUSTRALIA PTY LTD
3 Acacia Place, Notting Hill VIC 3168, Australia
Customer Service: 1300 132 992
www.olympusaustralia.com.au

OLYMPUS NEW ZEALAND LIMITED
28 Corinthian Drive, Albany, Auckland NZ 0632
Customer Service: 0508 659 6787
www.olympus.co.nz

QR 07.203 V2.0 November 2019